

FEATURES

- Applications : Laptop Computer, Rechargeable battery packs, Lithium Cell and battery packs
- Product Features : Low profile, Solid state,
- Operation Current: 1.9A ~ 7.3A
- Maximum Voltage: 15Vdc ~ 20Vdc
- Temperature Range: -40°C to 85°C

AGENCY RECOGNITION

Made for RFE by UL shop Fuzetec

- UL (E211981)
- C-UL (E211981)
- TÜV (R50004084)

ELECTRICAL CHARACTERISTICS (23°C)

Part Number	Hold Current	Trip Current	Max. Time to Trip	Rated Voltage	Maximum Current	Typical Power	Resistance		
	I _H , A	I _T , A	at 5 x I _H , s	V _{MAX} , Vdc	I _{MAX} , A	P _d , W	R min Ohms	R max Ohms	R1 max Ohms
FLR190F	1.90	3.90	5	15	100	1.2	0.039	0.072	0.102
FLR260F	2.60	5.80	5	15	100	2.5	0.020	0.042	0.063
FLR380F	3.80	8.30	5	15	100	2.5	0.013	0.026	0.037
FLR450F	4.50	8.90	5	20	100	2.5	0.011	0.020	0.028
FLR550F	5.50	10.50	5	20	100	2.8	0.009	0.016	0.022
FLR600F	6.00	11.70	5	20	100	2.8	0.007	0.014	0.019
FLR730F	7.30	14.10	5	20	100	3.3	0.006	0.012	0.015

I_H=Hold current-maximum current at which the device will not trip at 23°C still air.
 I_T=Trip current-maximum current at which the device will always trip at 23°C still air.
 V_{MAX}=Maximum voltage device can withstand without damage at its rated current.
 I_{MAX}=Maximum fault current device can withstand without damage at rated voltage (V_{MAX}).
 P_d=Typical power dissipated from device when in the tripped state in 23°C still air environment.
 R_{MIN}=Minimum device resistance at 23°C.
 R1_{MAX}=Maximum device resistance at 23°C, 1 hour after tripping.

Physical specifications:
 Lead material: 0.13mm nominal thickness, quarter-hard nickel.
 Insulating material: Polyester tape

THERMAL DERATING CURVE

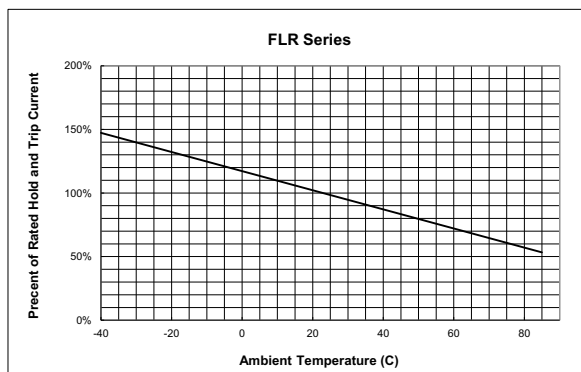

NOTE: All Specifications subject to change without notice.

■ **DIMENSIONS (mm)**

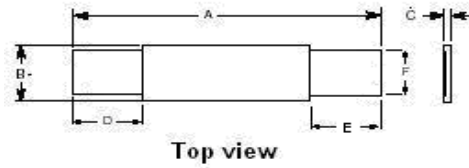

Part Number	A		B		C		D		F	
	Min	Max	Min	Max	Min	Max	Min	Max	Min	Max
FLR190F	19.90	22.10	4.90	5.50	0.60	1.00	5.50	7.50	3.90	4.10
FLR260F	20.90	23.10	4.90	5.50	0.60	1.00	4.10	5.50	3.90	4.10
FLR380F	24.00	26.00	6.90	7.50	0.60	1.00	4.10	5.50	4.90	5.10
FLR450F	24.00	26.00	9.90	10.50	0.60	1.00	5.30	6.70	5.90	6.10
FLR550F	35.00	37.00	6.90	7.50	0.60	1.00	5.30	6.70	4.90	5.10
FLR600F	24.00	26.00	13.90	14.50	0.60	1.00	4.10	5.50	5.90	6.10
FLR730F	27.10	29.10	13.90	14.50	0.60	1.00	4.10	5.50	5.90	6.10

■ **TYPICAL TIME-TO-TRIP AT 23°C**

- A = FLR190F**
- B = FLR260F**
- C = FLR380F**
- D = FLR450F**
- E = FLR550F**
- F = FLR600F**
- G = FLR730F**

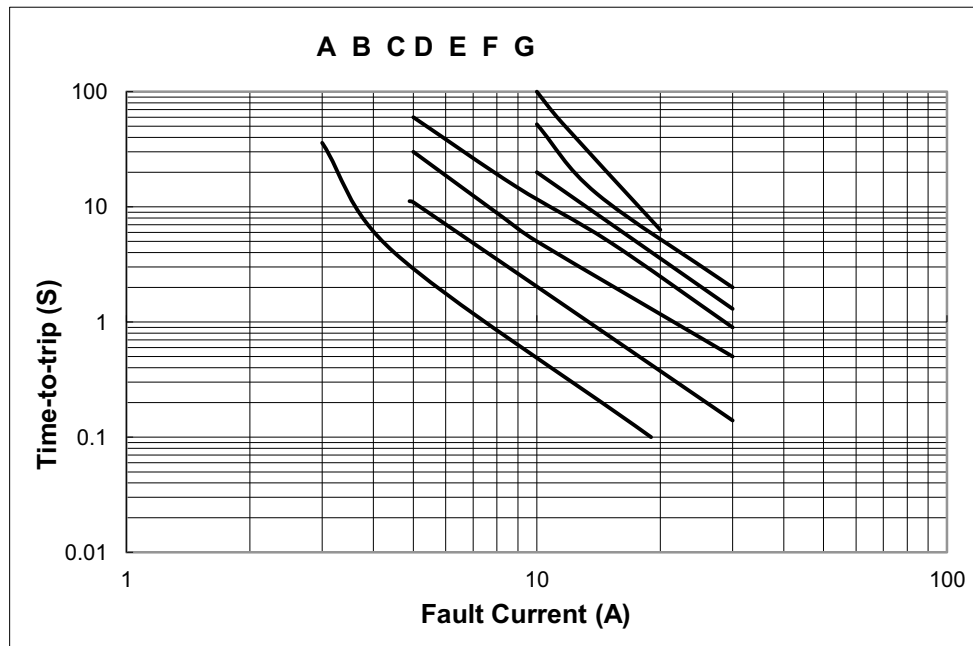

■ **MARKING SYSTEM**

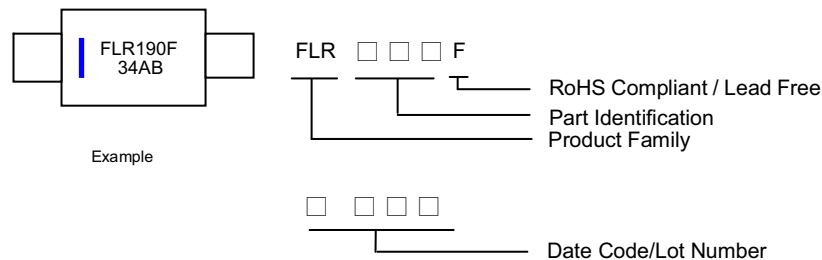

NOTE: All Specifications subject to change without notice.