

■ FEATURES

- Epoxy meets UL-94 V-0 flammability rating
- Moisture Sensitivity Level 1
- Fast switching speed
- High Conductance
- Surface mount package ideally Suited for Automatic Insertion

■ MECHANICAL DATA

- **Package:** SOT-323
- **Terminals:** Tin plated leads, solderable per J-STD-002 and JESD22-B102
- **Marking:** A2

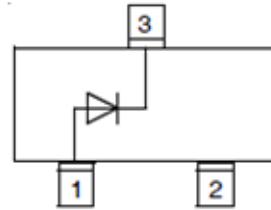

■ MAXIMUM RATINGS (T_a=25°C Unless otherwise specified)

Item	Symbol	Unit	Value
Non-Repetitive Peak Reverse Voltage	V _{RM}	V	100
Reverse Voltage	V _R	V	100
Peak Forward Current	I _{FAV}	mA	150
Thermal Resistance from Junction to Ambient	R _{θJA}	°C/W	625
Operation Junction Temperature	T _J	°C	-55 to +150
Storage Temperature	T _{STG}	°C	-55 to +150

■ ELECTRICAL CHARACTERISTICS (T_a=25°C Unless otherwise specified)

Item	Symbol	Unit	Conditions	Value
Reverse Voltage	V _R	V	I _R =100uA	100
Maximum Instantaneous Forward Voltage	V _F	V	I _F =1mA	0.715
			I _F =10mA	0.855
			I _F =50mA	1.0
			I _F =150mA	1.25
Maximum DC Reverse Current	I _R	uA	V _R =75V	2.5
Maximum Junction Capacitance	C _J	pF	f=1.0MHz, V _R =0V	4
Maximum Reverse Recovery Time	T _{rr}	ns	I _F =I _R =10mA, I _{rr} =0.1*I _R , R _L =100Ω	4

■ **PACKAGING INFORMATION**

PREFERRED P/N	PACKING CODE	UNIT WEIGHT(g)	MINIMUM PACKAGE(pcs)	INNER BOX QUANTITY(pcs)	OUTER CARTON QUANTITY(pcs)	DELIVERY MODE
BAS16WT	F2	Approximate 0.005	3000	30000	120000	7" reel

■ **CHARACTERISTICS (TYPICAL)**

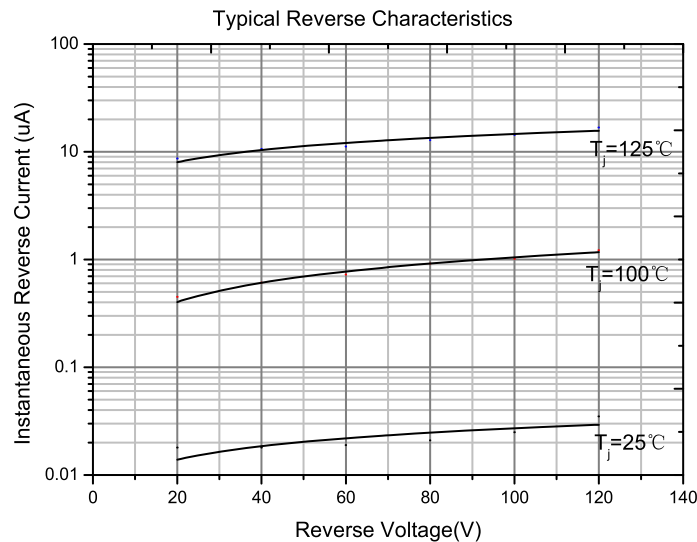
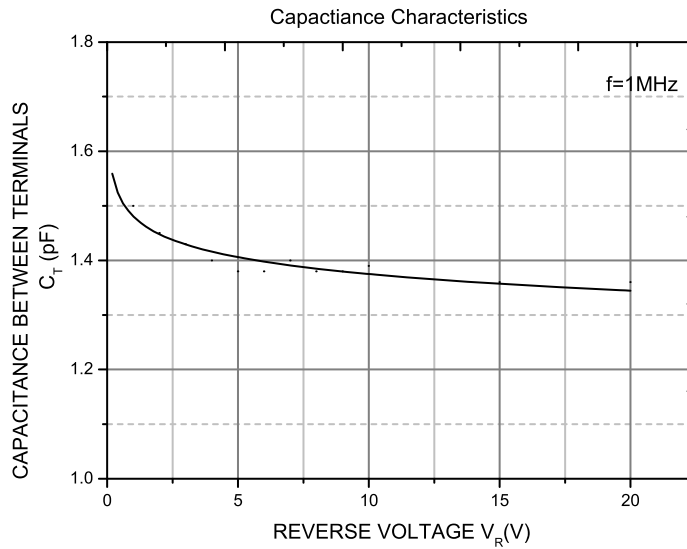
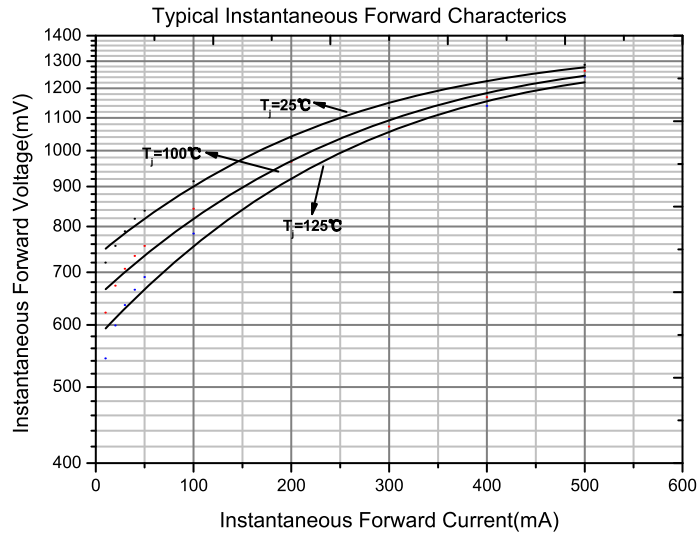

■ **SOT-323 PACKAGE OUTLINE DIMENSIONS**

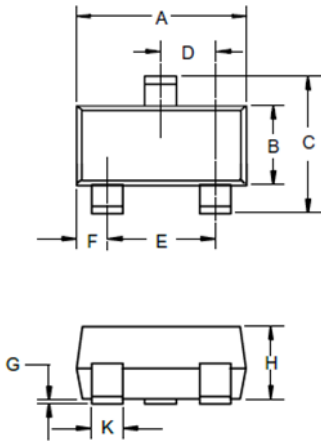

DIMENSIONS					
DIM	INCHES		MM		NOTE
	MIN	MAX	MIN	MAX	
A	.071	.087	1.80	2.20	
B	.045	.053	1.15	1.35	
C	.083	.096	2.10	2.45	
D	.026 Nominal		0.65Nominal		
E	.047	.055	1.20	1.40	
F	.012	.016	.30	.40	
G	.000	.004	.000	.100	
H	.035	.039	.90	1.00	
J	.004	.010	.100	.250	
K	.006	.016	.15	.40	

■ **SOT-323 SUGGESTED PAD LAYOUT**

