

### ■ FEATURES

- High efficiency
- High current capability
- High reliability
- High surge current capability
- Low power loss
- Glass passivated chip junction
- Solder dip 275 °C max. 7 s, per JESD 22-B106

### ■ MECHANICAL DATA

- Package: Package: R-6  
Molding compound meets UL 94 V-0 flammability rating, RoHS-compliant
- Terminals : Tin plated leads, solderable per J-STD-002 and JESD22-B102
- Polarity: Color band denotes cathode end

### ■ MAXIMUM RATINGS (T<sub>a</sub>=25°C Unless otherwise specified)

PARAMETER	SYMBOL	UNIT	10A05 G	10A1G	10A2G	10A4G	10A6G	10A8 G	10A10 G
Device marking code			10A05G	10A1G	10A2G	10A4G	10A6G	10A8G	10A10G
Repetitive Peak Reverse Voltage	V <sub>RRM</sub>	V	50	100	200	400	600	800	1000
Average Forward Current @60Hz sine wave, Resistance load, T <sub>a</sub> =50 °C	I <sub>F(AV)</sub>	A	10.0						
Forward Surge Current (Non-repetitive) @60Hz Half-sine wave, 1 cycle, T <sub>a</sub> =25°C	I <sub>FSM</sub>	A	300						
Storage Temperature	T <sub>stg</sub>	°C	-55 ~+150						
Junction Temperature	T <sub>j</sub>	°C	-55~+150						

### ■ ELECTRICAL CHARACTERISTICS (T<sub>a</sub>=25°C Unless otherwise specified)

PARAMETER	SYMBOL	UNIT	TEST CONDITIONS	10A05G	10A1G	10A2G	10A4G	10A6G	10A8G	10A10G
Maximum instantaneous forward voltage drop per diode	V <sub>FM</sub>	V	I <sub>FM</sub> =10.0A	1.1						
Maximum DC reverse current at rated DC blocking voltage per diode	I <sub>RRM1</sub>	μA	T <sub>a</sub> =25°C	2.5						
	I <sub>RRM2</sub>		T <sub>a</sub> =100°C	50						
Typical junction capacitance	C <sub>j</sub>	pF	Measured at 1MHZ and Applied Reverse Voltage of 4.0 V.D.C.	60						

### ■ THERMAL CHARACTERISTICS (T<sub>a</sub>=25°C Unless otherwise specified)

PARAMETER	SYMBOL	UNIT	10A05G	10A1G	10A2G	10A4G	10A6G	10A8G	10A10G
Thermal Resistance(Typical)	R <sub>θJ-A</sub>	°C/W	10						

## ■ PACKAGING INFORMATION

PREFERRED P/N	PACKAGE CODE	UNIT WEIGHT(g)	MINIMUM PACKAGE(pcs)	INNER BOX QUANTITY(pcs)	OUTER CARTON QUANTITY(pcs)	DELIVERY MODE
10A05G~10A10G	D1	Approximate 1.95	500	500	5000	Tape
10A05G~10A10G	C1	Approximate 1.95	100	100	5000	Bulk

## ■ CHARACTERISTICS (TYPICAL)

FIG.1: I<sub>o</sub>-T<sub>a</sub> Curve

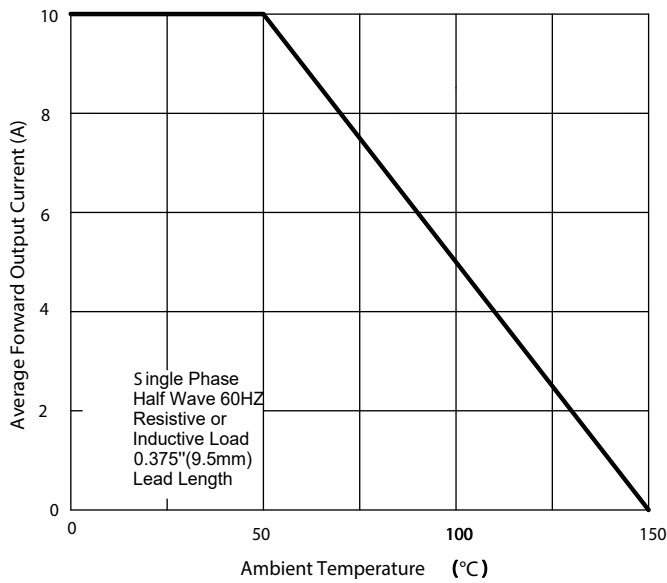

FIG.2 : Forward Surge Current Capability

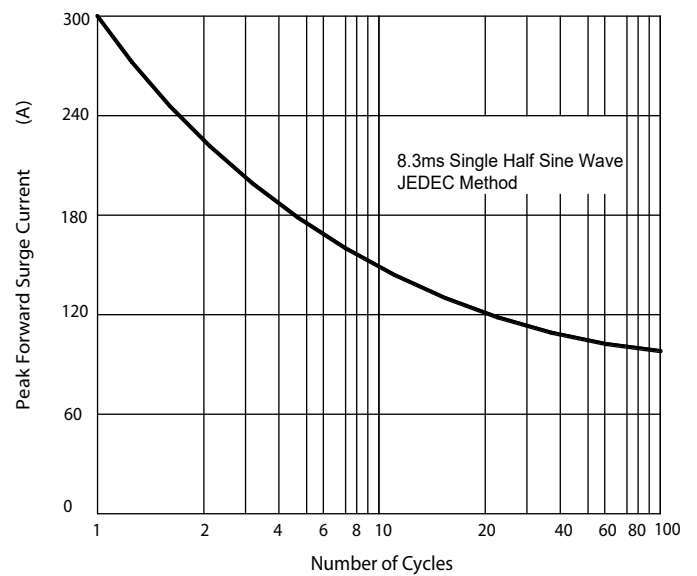

FIG.3: Forward Voltage

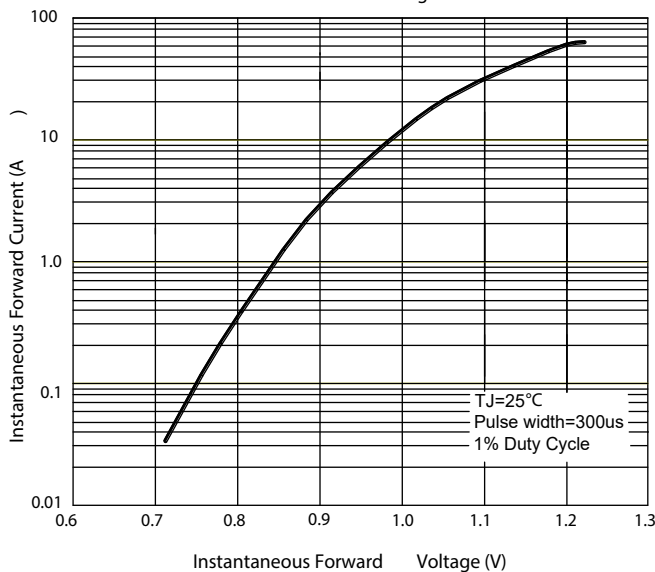
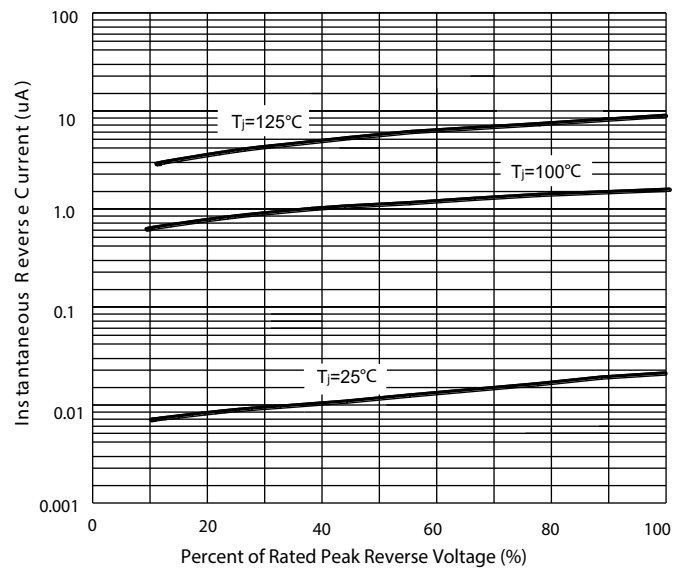
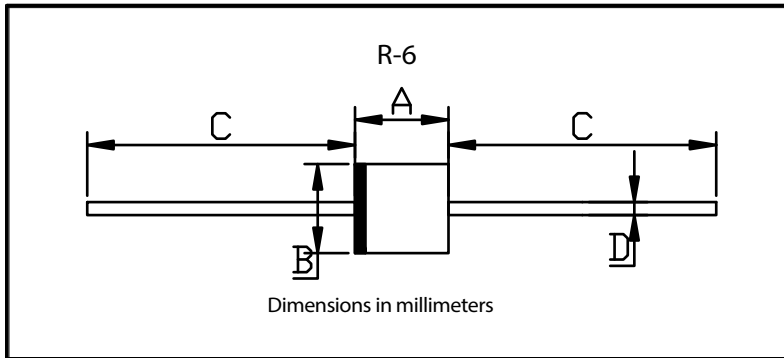

FIG.4: Typical Reverse Characteristics



■ **OUTLINE DIMENSIONS**



R-6		
Dim	Min	Max
A	8.60	9.10
B	8.60	9.10
C	25.4	/
D	1.20	1.32